

**SOUTHERN POWER DISTRIBUTION COMPANY OF A.P. LIMITED  
TIRUPATI**

**Memo.No.ED/P&MM. & IPC/SPDCL/TPT/CIVIL/F.210/D.No.2633 /13 dt. 23-11-2013**

Sub: SPDCL – Consolidated SPDCL SSR for the year 2013-14 – Issued – Reg.

Ref :- Note orders dated 22-11-2013 of Chairman & Managing Director  
APSPDCL

\*\*\*

With reference to the note orders dated 22-11-2013 ,the rates of SSR 2012-13 are revised and new SSR for the year 2013-14 is finalized. This SSR is effective from the date of issue of SSR 2013-14.

Finalized copy of SSR is being sent through E-mail to all Chief Engineers/ Superintending Engineers/Divisional Engineers/Executive Engineers/Assistant Divisional Engineers/ Assistant Engineers/ Additional Assistant Engineers for implementation in the SPDCL from now onwards.

Encl: One copy of SPDCL  
SSR 2013-14.  
// FBO //

**Sd/- T. VANAJA  
EXECUTIVE DIRECTOR  
P&MM & IPC  
APSPDCL :: TIRUPATI**

**EXECUTIVE ENGINEER, CIVIL**

To

All Superintending Engineers/ Operation/SPDCL  
The Executive Engineer, Civil, Corporate Office, APSPDCL, Tirupati.  
All Divisional Engineers/ Operation/ SPDCL  
All Divisional Engineers/ Transformers/ SPDCL  
All Divisional Engineer/ M&P/ SPDCL  
All Divisional Engineers/ Construction/SPDCL  
All Asst Div. Engineers/ Operation/ SPDCL  
All Assistant Engineers & Addl. Asst. Engineers/ Operation/ SPDCL

**Copy to**

The Chief Engineer/ Zone/ SPDCL/ Tirupati & Vijayawada.  
The Chief General Manager/ Projects/ SPDCL/ Tirupati.  
The Chief General Manager/ Opn./ SPDCL/ Tirupati.  
The Chief General Manager/Finance/SPDCL/ Tirupati.  
The Superintending Engineer / DPE/ SPDDL/Tirupati  
The Superintending Engineer / Assessments/ SPDCL/Tirupati.  
The Divisional Engineer/ DPE/ SPDCL  
The Divisional Engineer/ Assessments/ SPDCL  
Copy submitted to Peshi of Director/ Operation/ SPDCL/ Tirupati.  
Copy submitted to Peshi of Director/Finance/ SPDCL/ Tirupati.  
Copy submitted to Peshi of Director/ HRD/ SPDCL/ Tirupati.  
Copy submitted to Peshi of Director/ Projects/ SPDCL/ Tirupati.  
Copy submitted to Peshi of Chairman & Managing Director/ SPDCL/ Tirupati.

# SOUTHERN POWER DISTRIBUTION COMPANY OF ANDHRA PRADESH LIMITED



## COMMON STANDARD SCHEDULE OF RATES FOR THE YEAR 2013 - 2014

### INDEX

| Description                                | Page No. |
|--|----------|
| <b>I. Rates of Labour</b>                  | 1-2      |
| <b>II. Important note</b>                  | 3        |
| <b>III. Rates of Works</b>                 | 4-17     |
| <b>IV. Loading &amp; Unloading Charges</b> | 18-21    |
| <b>V. Transport Charges</b>                | 22-25    |

## **I. RATES OF LABOUR**

| Sl No. | Type of Labour  | Unit | Rate   |
|--------|---|------|--------|
| 1)     | <b>First Class-</b> Mason/ Brick Layer/Carpenter/<br>Painter/Plumber/Welder/Fitter/Electrician/Mechanic   | Day  | 400.00 |
| 2)     | <b>Second Class -</b> Mason/ Brick Layer/Carpenter/<br>Painter/Plumber/Welder/Fitter/Electrician/Mechanic   | Day  | 320.00 |
| 3)     | <b>Un-Skilled Work Men/Women</b>  | Day  | 280.00 |
|        | AREA ALLOWANCES :-  |      |        |
|        | <p><b>A. CORPORATIONS &amp; MUNICIPALITIES:-</b></p> <p>a) i) 25% extra over the rates on labour component of works is allowed in all Municipal Corporation Limits except Vijayawada Municipal Corporations ( <i>up to a belt of 12 Kms. from Municipal Corporation limits</i>) and other Corporations as notified by the Government from time to time.</p> <p>ii) 40% extra over basic rates on labour component of works for Vijayawada Municipal Corporations ( <i>Up to belt of 12 Kms from Municipal Corporation limits</i>).</p> <p>b) Allow 20% extra over basic rates on labour component of works in all District Head Quarters and the remaining Municipal limits (<i>up to a belt of 12 Kms from Municipal limits</i>).</p> <p>c) For works at Tirumala Hills in Chittoor District, 40% extra over the basic rates of labour component is allowed.</p> <p>d) For works at Horsely Hills in Chittoor District, 30% extra over the basic rates of labour component is allowed.</p> |      |        |
|        | <p><b>B. Jail Compounds:</b><br/>20 % extra</p>   |      |        |
|        | <p><b>C. .INDUSTRIAL AREA:-</b><br/>Allow 20% extra over rates on labour component of works in the following Industrial Areas. (<i>within 10 Kms belt of Industrial area</i>)</p> <p>KRISHNA DIST.- Ibrahimpatnam Distribution, Vuyyuru Distribution, Jaggaiahpetta Distribution.</p> <p>GUNTUR DIST.- Macherla Distribution, Gurajala, Distribution, Dachehalli Distribution, Piduguralla Distribution</p> <p>ONGOLE DIST.- Cheemakurthy Distribution, Maddipadu Distirbution</p> <p>NELLORE DIST.- Tada Distribution, Muthukur Distribution, Chillakur Distribution, Menakur Distribution, Kodavalur Distribution</p>   |      |        |

|  |  |  |  |
|--|--|--|--|
|  | <p>CHITTOOR DIST.- Renigunta. Distribution, Gurajala<br/>Mandyam distribution, Kuppam<br/>Distribution, Satyavedu Distribution,<br/>KADAPA DIST.- Yerraguntla Distribution, Mangampeta<br/>Distribution, Jammalamadugu<br/>Distribution</p>  |  |  |
|  | <p>NOTE:- If more than one area allowance(Such as those) for (1)<br/>Corporations (2) Municipalities and District Head<br/>Quarters (3) Industrial Area are applicable for a<br/>particular situation, only the maximum out of the<br/>allowable percentages is to be allowed.</p> |  |  |

## II. IMPORTANT NOTE

- (1) Specific approval is to be taken from the corporate office in respect of blasting works.
- (2) Extra percentage is not allowed for LC Period works/ shut down period works.
- (3) 9.1m/280 Kg Poles shall be utilised in Towns and 33 KV lines only.
- (4) All Fabrication works should be done by using departmental materials within stores Yard/premises only. Department materials shall not be issued to the out side the stores for fabrication purpose. Divisional/Tech shall personally monitor the issue of fabrication of materials.
- (5) All the estimates shall be prepared based on the rates of SSR only. For the items not covered in the SSR, approval is to be taken from the concerned SE, Operation.
- (6) Pole pit concreting is normally not allowed for PSCC/Spun poles. If concreting is to be done in certain cases, then specific approval is to be taken from the concerned SE, Operation.
- (7) Basic/Bed concreting is necessary for spun poles, if pole pit concreting is allowed.
- (8) Red oxide primer painting is not allowed in respect of old structures/equipment in 33/11 KV SS. Only one coat of aluminium/synthetic/ black bitumen paint is allowed.
- (9) No extra percentage/rate towards area allowance in respect of (a) loading & unloading charges (b) Fabrication of line materials (c) Dismantling and re-erection of Single Phase/Three Phase services is allowed

### III. RATES OF WORKS

| Sl No.    | Description  | Per | Rate    |
|-----------|--|-----|---------|
|           | <b>EXCAVATION OF PITS</b>  |     |         |
| <b>1)</b> | Excavation of pits <b>in all soils</b> i.e., mixture of gravel and soft disintegrated rock like shales ordinary gravel, stoney earth and earth mixed with fair sized boulders.   |     |         |
| <b>a)</b> | 2' x 2'6" x 5' or<br>0.6m x 0.75m x 1.5m (for 8m or 9.1m PSCC poles)   | Pit | 197.00  |
| <b>b)</b> | 2' x 2'6" x 5'6" or<br>0.6m x 0.75m x 1.65m (for 10m Joists/ rail poles)   | Pit | 209.00  |
| <b>c)</b> | 3' x 3' x 6' or<br>0.9m x 0.9m x 1.8m. (for 11m spun/Joist poles)  | Pit | 231.00  |
| <b>d)</b> | 3' x3' x 7' or<br>0.9m x 0.9m x 2.1m. (for 12.5 spun poles)  | Pit | 266.00  |
| <b>2)</b> | Excavation of pits in excavation <b>in soft disintegrated rock removable by pick axes</b>  |     |         |
| <b>a)</b> | 2' x 2'6" x 5' or<br>0.6m x 0.75m x 1.5m (for 8m or 9.1m PSCC poles)   | Pit | 220.00  |
| <b>b)</b> | 2' x 2'6" x 5'6" or<br>0.6m x 0.75m x 1.65m (for 10m Joists/ rail poles)   | Pit | 231.00  |
| <b>c)</b> | 3' x 3' x 6' or<br>0.9m x 0.9m x 1.8m. (for 11m spun/Joist poles)  | Pit | 255.00  |
| <b>d)</b> | 3' x3' x 7' or<br>0.9m x 0.9m x 2.1m. (for 12.5 spun poles)  | Pit | 289.00  |
| <b>3)</b> | Excavation of pits <b>in hard rock by blasting</b><br><b>Note:-</b> 1) Specific approval is to be taken from the corporate office in respect of blasting works.<br>2) Quantity of excavation actually done as per specification and plans only is to be admitted, irrespective of total excavation of the pit.:-   |     |         |
| <b>a)</b> | 2' x 2'6" x 5' or<br>0.6m x 0.75m x 1.5m (for 8m or 9.1m PSCC poles)   | Pit | 694.00  |
| <b>b)</b> | 2' x 2'6" x 5'6" or<br>0.6m x 0.75m x 1.65m (for 10m Joists/ rail poles)   | Pit | 763.00  |
| <b>c)</b> | 3' x 3' x 6' or<br>0.9m x 0.9m x 1.8m. (for 11m spun/Joist poles)  | Pit | 1498.00 |
| <b>d)</b> | 3' x3' x 7' or<br>0.9m x 0.9m x 2.1m. (for 12.5 spun poles)  | Pit | 1748.00 |
| <b>e)</b> | Rate per cft   | cft | 28.00   |
|           | <b>ERECTION OF LINES</b>   |     |         |
| <b>4)</b> | <b>PSCC/SPUN/RAIL POLES ERECTION</b> :-Erection of PSCC Poles in position aligning and setting to work as per specification including supply of labour for survey, pit- marking, T&P, transport of 1 No. PSCC Pole from road side to location including loading and unloading and back filling the earth ramming for consolidation but excluding the cost of pit excavation. |     |         |

|    |   |      |         |
|----|---|------|---------|
|    | <b>PSCC Poles</b>   |      |         |
| a) | 8.0 m /140 Kg PSCC Poles ( Weight of pole=355 Kg)   | Each | 752.00  |
| b) | 8.0 m /200 Kg PSCC Poles ( Weight of pole=380 Kg)   | Each | 805.00  |
| c) | 8.0 m /300 Kg PSCC Poles ( Weight of pole=505 Kg)   |      |         |
| d) | 9.1 m / 280 Kg PSCC poles ( Weight of pole=680 Kg)  | Each | 1440.00 |
| e) | 11.0 m / 365 Kg PSCC poles ( Weight of pole=1127 Kg)  | Each | 2430.00 |
|    | <b>Spun poles</b>   |      |         |
| f) | 9.5 m Spun Pole ( Weight of pole=620 Kg)  | Each | 2130.00 |
| g) | 11.0 m Spun poles ( Weight of pole=900 Kg)  | Each | 3091.00 |
| h) | 12.5 m Spun Poles ( Weight of pole=1,200 Kg)  | Each | 4122.00 |
|    | <b>Rail Poles</b>   |      |         |
| i) | 60 Lbs / 27.3kg-. Rail poles- Length of Rail pole – 27’(8.23m)<br>( Weight of pole=225 Kg)  | Each | 477.00  |
| j) | 75 Lbs / 34.1kg. Rail poles- Length of Rail pole – 30’(9.14m)<br>( Weight of pole=312 Kg)   | Each | 661.00  |
| k) | 90 Lbs / 40.9kg. Rail poles- Length of Rail pole – 30’(9.14m)<br>( Weight of pole=374 Kg)   | Each | 792.00  |
| l) | 105 Lbs / 47.7kg. Rail poles- Length of Rail pole – 30’(9.14m)<br>( Weight of pole=436 Kg)  | Each | 921.00  |
|    | <b>RS Joist Poles</b>   |      |         |
| m) | 150x75 RS Joist Poles –Length of Joist – 9M<br>( Weight of pole=140 Kg)   | Each | 295.00  |
| n) | 175x85 RS Joist Poles –Length of Joist – 9M<br>( Weight of pole=215 Kg)   | Each | 455.00  |
| o) | 150x150 RS Joist Poles –Length of Joist – 9M<br>( Weight of pole=333 Kg)  | Each | 703.00  |
| 5) | <b><u>STAY SET ERECTION</u></b>   |      |         |
| a) | <b><u>Stay erection ( 33 KV line or 11 KV line or LT Line ) Data for each Stay set :-</u></b> Assembly and erection of Stay set made out of M.S. Rod 20 mm by burying Stay Rods with base plate in alignment with line / bisection, back billing with earth and ramming for Consolidation including fixing of guy in Stay wire of 7/12 clamps, turn buckles etc., on the Pole and binding on either side and as per specification and transporting materials and T&P from road side to work spot including loading and unloading, but excluding cost of pit excavation. | Set  | 223.00  |
| 6) | <b><u>ERECTION OF CROSS ARMS</u></b>  |      |         |
| a) | <b><u>Fixing of 1 No. 5’ – 0’’ – Channel ( 100 X 50 mm) – V – X – Arms for 33 KV:-</u></b> Fixing of 1 No. 5’ – 0’’ – Channel ( 100 X 50 mm) – V – X – Arms ( for 33 KV line) to already erected 9.1 M PSCC with 1 No. Back Clamp made out of 75 X 6 mm M.S. Flat including transporting of materials and T&P from road side to location with loading and unloading   | Each | 92.00   |
| b) | <b><u>Fixing of 33 KV Top fitting :-</u></b> Fixing of 1 No. 33 KV Top – fitting ( MS Channel 100 X 50 mm ) with 2 Clamps ( MS flat 75 X 8 mm) to the already erected 9.1 M PSCC Pole including transporting of materials and T&P from road side to location with loading and unloading.  | Each | 43.00   |
| c) | <b><u>Fixing of 11 KV 3’ – 6’’ – V – X- Arm :-</u></b> Fixing of 1 No. 3’ – 6’’ –   | Each | 55.00   |

|    |  |       |        |
|----|--|-------|--------|
|    | V – X – arm made out of M.S. Channel 75 X 100 mm to the already erected 8M PSCC Pole with 1 No. Back Clamp made out of 75 X 8 mm M.S. Flat as per specification and drawing aligning them properly and setting to work including transporting of materials and T&P from road side to location with loading and unloading   |       |        |
| d) | <b><u>Fixing of 11 KV Top – Fittings :-</u></b> Fixing of 1 No. 11 KV Top – fittings made out of 65 X 65 X 6 mm Angle to the already erected 8M PSCC Pole with 2 Nos. B.Cs made out of 50 X 6 mm MS Flat as per specification and aligning them properly and setting to work including transporting from road side to location loading and unloading                           | Each  | 33.00  |
| e) | <b><u>Fixing of LT 3 phase/ Single phase ‘X’ Arm:-</u></b> Fixing of 1 No. LT 3 phase/single ‘X’ –arms with 1 No. back clamp to the erected all types of poles as per specification and drawing aligning them properly and setting to work including transporting of materials and T&P from road side to location with loading and unloading                                   | Each  | 39.00  |
| f) | <b><u>Fixing of L.T. Top fitting :-</u></b> Fixing of 1 No. L.T. Top fitting made out of M.S Angle 50X50X6 mm to the already erected 8M PSCC Pole with 2 Nos. back Clamps made out of M.S. Flat as per specifications and drawing aligning them properly and setting to work including transporting of material and T&P from road side to location with loading and unloading. | Each  | 26.00  |
| g) | <b><u>Fixing of 11 KV/ LT side arm with strut</u></b>  | Each  | 92.00  |
| h) | <b><u>Fixing of 11 KV/ LT box type side arm with strut</u></b>   | Each  | 119.00 |
| 7) | <b><u>FIXING OF INSULATORS</u></b>   |       |        |
| a) | <b><u>Fixing one No. 33 KV Insulator and Pin:-</u></b> Fixing of 33 KV Insulator as per the specification and drawing and aligning them properly to work, transportation of 33 KV insulators and pin from road side to location including loading and unloading  | Each  | 35.00  |
| b) | <b><u>Fixing of 33 KV Discs with MPS ( i.e., 3 Nos. Discs and 1 set MPS )</u></b>  | 1 set | 120.00 |
| c) | <b><u>33 KV Polymer disc</u></b>   | Each  | 60.00  |
| d) | <b><u>Fixing 1 No. 11 KV Disc with MPS :-</u></b> Fixing of 11 KV metal part along with 11 KV Disc to Cross arm as per specification and drawing aligning them properly and setting to work, transporting of materials and T&P from road side to location including loading and unloading  | Each  | 49.00  |
| e) | <b><u>11 KV Polymer disc</u></b>   | Each  | 26.00  |
| f) | <b><u>Fixing of one 11 KV Pin insulator &amp; Pin :-</u></b>   | Each  | 22.00  |
| g) | <b><u>Fixing of LT Pin Insulators &amp; GI Pins, LT shackles with MPS and CI Knobs</u></b>   | Each  | 22.00  |
| 8) | <b><u>Erection of Line D.P.S :-</u></b> Assembly, erection, aligning line, D.P. Structure and setting to work as per drawing general specifications including transport of materials and T&P from road side to location, loading and unloading, providing of watch and ward till the line pre – handed over but excluding the cost of pit excavation :-                        |       |        |
| 9) | <b><u>STRUT - ERECTION</u></b>   |       |        |



|             |   |          |  |
|-------------|---|----------|--|
| <b>10)</b>  | <b><u>Paving , Stringing &amp; Jumpering of Conductor :-</u></b> Fixing of suitable rollers, bamboos, paving out Conductor on suitable supports, providing temporary stays, tensioning, sagging correctly, fixing at strain point, transporting to pin points, binding, rectification of poles, guys and jumpering as per specification and drawing for 3 Nos. of 34 Square mm AAA Conductor including transporting of materials and T&P from road side to location including loading and unloading and providing watch and ward till the lines are handed over( <b>Rate per Km/Per conductor</b> ) |          |  |
| <b>a)</b>   | Dog conductor weighing 393Kg/Km   | Per Km/C | <b>DELETED</b>   |
| <b>b)</b>   | 100 sq.mm.AAA weighing 272.86 Kg/Km   | Per Km/C | 4833.00  |
| <b>c)</b>   | 7/3.35 ACSR or 55 sqmm., AAA conductor weighing 149.2 Kg/Km   | Per Km/C | 2644.00  |
| <b>d)</b>   | 7/2.59 ACSR or 34 sqmm., AAA conductor weighing 94 Kg/Km  | Per Km/C | 1664.00  |
| <b>e)</b>   | AB cable 1x16 + 25mm. weighing 120 Kg/Km  | Per Km   | 2125.00  |
| <b>f)</b>   | AB cable 2x16 + 25mm weighing 189 Kg/Km   | Per Km   | 3349.00  |
| <b>g)</b>   | AB cable 3x16+25mm weighing 258 Kg/Km   | Per Km   | 4570.00  |
| <b>h)</b>   | 185 sqmm 11 KV AB cable   | Per Km   | <b>DELETED</b>   |
| <b>11)</b>  | <b><u>CONCRETING ITEMS :-</u></b><br>Note:- 1) <b>Pole pit Concreting is normally not allowed</b> for PSCC/Spun poles. If concreting is to be done in certain cases, then specific approval is to be taken from the concerned SE, Operation.<br>2) Basic /Bed concreting is necessary for spun poles, if pole pit concreting is allowed.  |          | <b>DELETED. To be worked out as per Govt. SSR by the respective circle office ADEs/CIVIL</b> |
| <b>a)</b>   | <b><u>Concreting of pole pit</u></b><br>Concreting of pole pit of size =2'x2'6"x5' (0.6m x 0.75m 1.5 m.) with C.C.(1:4:8) using 40 mm. HBG metal including cost and Transport of all materials, labour charges, Transport of T & P and labour etc..   |          |  |
| <b>i)</b>   | Labour charges in Rural areas   |          |  |
| <b>ii)</b>  | Material(40mm HBG Metal + sand ) up to 5Km lead   |          |  |
| <b>iii)</b> | Cement  |          |  |
| <b>iv)</b>  | Total (Labour + Material + Cement)  |          |  |
| <b>b)</b>   | <b><u>Concreting of stay pit</u></b><br>Concreting of stay pit of size 1' x 1'-6" x 4' (0.3mx0.45x1.2m) with C.C. (1:4:8) using 40 mm., HBG metal including cost and Transport of all materials, labour charges all leads & lifts etc.,   |          |  |
| <b>i)</b>   | Labour charges in Rural areas   |          |  |
| <b>ii)</b>  | Material(40mm HBG Metal + sand ) up to 5Km lead   |          |  |
| <b>iii)</b> | Cement  |          |  |
| <b>iv)</b>  | Total (Labour + Material + Cement)  |          |  |

|      |  |  |   |
|------|--|--|---|
| c)   | <p><b><u>Construction of 1No. VCB plinth of size 5'6" x 5' x 3'6"</u></b><br/> Excavation of pit of size 5'6"x5'x3', filling with sand for 6" depth, laying bed concrete with CC(1:4:8) using 40mm HBG metal for 4" depth, Construction of VCB plinth of size 5'6" x 5' x 3'6" (1.65m x 1.5m x 1.05m) with CC (1:3:6) mix using 40 mm HBG metal and providing plastering in CM (1:5) 12mm thick for top and sides above G.L. portion and white washing two coats including cost and Transport of all materials and labour charges for all operations with an average lead of 5KM and lifts etc., complete as directed by the Engineer in charge</p>  |  |   |
| i)   | Labour charges in Rural areas  |  |   |
| ii)  | Material (40mm HBG Metal + sand +Janatha cem + Centering material hire charges) up to 5Km lead   |  |   |
| iii) | Cement   |  |   |
| iv)  | Total (Labour + Material + Cement)   |  |   |
| d)   | <p><b><u>Construction of 1No. Distribution transformer plinth of size 4'x4'x5'6" with brick masonry walls:-</u></b><br/> Excavation of pit of size 4'x4'x2', filling with sand for 1' depth, laying bed concrete with CC(1:4:8) using 40mm HBG metal for 4" depth, Construction of distribution transformer plinth with 9" thick 5'10" height brick masonry wall in CM (1:6) all-round, filling the hollow portion with sand, laying of 4" thick PCC (1:3:6) using 20 mm HBG metal on top and plastering all-round the outer side of wall with CM (1:5) 12mm thick and white washing two coats, including cost and Transport of all materials and labour charges for all operation with an average lead of 5 KM and lifts etc., complete as directed by the Engineer in charge.</p>        |  |   |
| i)   | Labour charges in Rural areas  |  |   |
| ii)  | Material (Bricks+ 40mm and 20mm HBG Metal + sand +Janatha cem cem + Centering material hire charges) up to 5Km lead  |  |   |
| iii) | Cement   |  |   |
| iv)  | Total (Labour + Material + Cement)   |  |   |
| 12)  | <p><b><u>Construction of pillar mounted. Distribution transformer plinth using RCC:-</u></b><br/> Excavation of pit of size 5'x5'x5', filling with sand for 4"( 10 cm) depth, laying bed concrete with CC(1:4:8) using 40mm HBG metal for 4" depth, Construction of distribution transformer plinth with footing size (5'x5'x4" and 3'x3'x1.5'), column size 9"x9"x8'8", beam size 9"x9"x9'3", slab size 5'x5'x4", providing reif steel 12mm rod (76 Kgs) as per the directions of ADE/Civil, re-filling the hollow portion with excavated earth, and slabs, column and beam with CM (1:5) 20mm thick, including cost and Transport of all materials and labour charges for all operation with an average lead of 5 KM and lifts etc., complete as directed by the Engineer in charge.</p> |  | <p><b>DELETED. To be worked out as per Govt. SSR by the respective circle office ADEs/CIVIL</b></p> |
| i)   | Labour charges in Rural areas  |  |   |
| ii)  | Material ( 40mm and 20mm HBG Metal + sand + Centering material hire charges) up to 5Km lead  |  |   |
| iii) | Cement   |  |   |
| iv)  | Steel  |  |   |

|      |  |  |          |
|------|--|--|----------|
| v)   | Total (Labour + Material + Cement)   |  |          |
| 13)  | <b><u>Construction of 1No. Distribution transformer plinth of size 4' dia and 6' height using RCC rings:-</u></b><br>Excavation of pit of size 4' dia 1'6" depth , laying one 40mm thick RCC cover on bottom/ground, laying seven RCC rings ( dia 4' and 1'height each) over RCC cover, filling the hollow portion with sand, providing 4" thick RCC cover on top and pointing all the joints with CM(1:5) including cost of all materials and labour charges. | <b>DELETED. To be worked out as per Govt. SSR by the respective circle office ADEs/CIVIL</b> |          |
| i)   | Labour charges   |  |          |
| ii)  | Material (Sand+ RCC rings+ RCC covers)   |  |          |
| iii) | Cement   |  |          |
| iv)  | Total (Labour + Material )   |  |          |
| 14)  | <b><u>Erection of 33/11 KV VCB:</u></b><br>Erection & Setting of 33/11 KV VCB with control panels on plinth carefully without causing any damages to bushings including transport, loading and unloading charges of VCB, Control cables, CTs and T&P etc labour charges complete including panel board wiring, testing and commissioning charges   | Each   | 13418.00 |
| 15)  | <b><u>Erection of 33 KV AB Switch:</u></b><br>Erection of 33 KV AB Switch on the booms including T&P and labour charges complete as per Dept standards   | Set  | 1457.00  |
| 16)  | <b>a) <u>Erection of 11 KV 400 Amps AB Switch:</u></b><br>Erection of 11 KV 400 Amps AB Switch on the booms including T&P and labour charges complete as per Dept standards  | Set  | 1092.00  |
|      | <b>b) <u>Erection of 11 KV AB Switch &amp; HG Fuse set:</u></b><br>Erection of AB Switch & HG Fuse set including transport from section office to work site, T&P labour charges complete as per department standards   | Set  | 1373.00  |
| 17)  | <b><u>Wiring of 3 Phase Distribution Transformer (100/63 KVA):</u></b><br>Wiring of 3 phase Distribution Transformer (100/63 KVA) with 95 Sqmm PVC Cable/conductor from transformer LV bushing to LT HG Fuse set and HG Fuse set to line with bear conductor supported on insulator fixed to fabricated LV frame   |  |          |
| a)   | Single Feeder with PVC cable   | Each   | 1296.00  |
| b)   | Double Feeder with PVC cable   | Each   | 2593.00  |
| c)   | Single Feeder with open wiring   | Each   | 1296.00  |
| d)   | Double Feeder with open wiring   | Each   | 2593.00  |
| 18)  | <b><u>Erection of pole mounting structure for erection of Single Phase / Three Phase Trasformers</u></b>   | Each   | 231.00   |
| 19)  | <b><u>Transformers Erection:</u></b><br>Erection of Distribution Transformer on the plinth/pole carefully without causing and damaged to bushing including labour and transport complete   |  |          |
| a)   | Single phase transformers 5 KVA on pole mounting structure   | Each   | 462.00   |
| b)   | Single phase transformers 15 KVA on pole mounting structure  | Each   | 694.00   |
| c)   | Three phase transformers 16/25KVA on pole mounting structure   | Each   | 925.00   |
| d)   | Transformers from 50 KVA to 160 KVA  |  | ---      |
| i)   | On plinth  | Each   | 1156.00  |
| ii)  | On structure   |  |          |

|      |   |      |          |
|------|---|------|----------|
| e)   | Transformers from 250 KVA to 315 KVA  |      |          |
| i)   | On plinth   | Each | 1387.00  |
| ii)  | On structure  |      |          |
| f)   | Erection/dismantling of healthy/sick PTR from plinth with accessories, radiators duly filling/draining out the oil and dragging the sick PTR to convenient locations for transport including stacking of radiators and accessories  |      |          |
| i)   | 3.15MVA   | Each | 5620.00  |
| ii)  | 5 MVA   | Each | 7025.00  |
| iii) | 8 MVA   | Each | 8430.00  |
| g)   | Erection of additional/new PTR including loading at Stores, unloading at site & erection of PTR at site.  |      |          |
| i)   | 3.15MVA   | Each | 16860.00 |
| ii)  | 5 MVA   | Each | 21075.00 |
| iii) | 8 MVA   | Each | 25290.00 |
| h)   | Replacement of sick PTR including loading of healthy PTR at Stores, unloading of healthy PTR at site, dismantling of sick PTR at site, Erection/commissioning of new PTR, loading of sick PTR at site and unloading of sick PTR at Stores etc.  |      |          |
| i)   | 3.15MVA   | Each | 33720.00 |
| ii)  | 5 MVA   | Each | 42150.00 |
| iii) | 8 MVA   | Each | 50580.00 |
| 20)  | <b><u>Erection of tilting/ horizontal type 11 KV AB Switch:-</u></b><br>Transporting of 11 KV tilting/horizontal type AB switch complete and required metallic supporting channels & studs for fixing to single pole structure so as to erect 11 KV tilting/horizontal type ABs and other parts connected to erection of the same from road side to location including loading & unloading. Erection of 11 KV tilting/horizontal type AB switch, on supporting channels, studs fitted to the pole set into operate freely i.e., opening & closing by fixing required number of guide angles, to pole and vertical operating pipe with handle including coil earthing of 11 KV tilting/horizontal type ABS handle as per standards. All the materials supplied by Department |      |          |
| a)   | <b><u>Erection of tilting type 11 KV AB Switch to Single pole DP Structure:-</u></b>  | Each | 867.00   |
| b)   | <b><u>Erection of horizontal type 11 KV AB Switch on DP Structure:-</u></b>   | Each | 970.00   |
| 21)  | <b><u>Erection of Earth Electrodes:</u></b><br>Erection of earth electrodes using CI/GI pipes including pit excavation, and cement collar of 2' dia x 1' height etc complete.   |      |          |
|      | a)GI Pipes  | Each | 521.00   |
|      | b)CI Pipes  | Each | 637.00   |
|      | Note:- In case GI/C.I Pipes are procured by the Contractor then 12% over SPDCL stores rate can be allowed for pipe cost .   |      |          |
| 22)  | <b><u>Erection of 33 KV HG Fuse set at Single Pole DTR Structure:-</u></b><br>Transporting of 33 KV H.G. Fuse set materials like post type insulators, Horns, pedestals etc., with seating Angles/Channels, made out of M.S. Angle from road side to location including loading   | Set  | 555.00   |

|     |   |                     |            |
|-----|---|---------------------|------------|
|     | & unloading and erection of 33 KV HG fuse set at required height as per standards with connected angles & Channels by adjusting the Horns to the required gap at single pole DTR structure. All the materials supplied by Departments.  |                     |            |
| 23) | <b><u>Erection of 11 KV HG Fuse set at Single Pole DTR Structure:-</u></b><br>Transporting of 11 KV H.G. Fuse set with seating Angles/Channels, side arms, made out of M.S. Angle with MS. Angle stud from road side to location including loading & unloading and erection of 11 KV HG fuse set at required height as per standards with connected angles & Channels by adjusting the Horns to the required gap at single pole DTR structure. All the materials supplied by Departments. | Set                 | 231.00     |
| 24) | <b><u>Erection of LT Fuse set at Single Pole DTR Structure:-</u></b><br>Transporting of LT Fuse set with seating Angles/Channels, side arms, made out of M.S. Angle with MS. Angle stud from road side to location including loading & unloading and erection of LT fuse set at required height as per standards with connected angles & Channels by adjusting the Horns to the required gap at single pole DTR structure. All the materials supplied by Departments.                     | Set                 | 173.00     |
| 25) | <b><u>Earthing of Distribution Transformers:</u></b><br>Running of No 8 G.I wire from Distribution Transformer (3 Phase) AB Switch, HG Fuse Set V'X' Arm etc running of 14 SWG G.I. Wire including double earthing as per specification for running of total 10 Nos GI wires.   | Per Lead Per length | 18.00      |
|     | Note:- In case GI wire is procured by the Contractor then 12% over SPDCL stores rate can be allowed for GI wire cost.   |                     |            |
| 26) | <b>Paving out and laying of 33KV/11 KV UG cable</b> duly forming the cable trench including excavation of trench 2'X2' filling the trench with excavated earth including transporting of cable etc. complete with out construction of trench.   |                     |            |
| a)  | 33 KV UG cable  | RM                  | 255.00     |
| b)  | 11 KV UG cable  | RM                  | 138.00     |
| 27) | Labour charges for erection of <b>11 KV cable heat shrunken joint</b>   | Each                | 3469.00    |
| 28) | Labour charges for erection of <b>33 KV cable heat shrunken joint</b>   | Each                | 4624.00    |
| 29) | <b>11 KV AB cable end termination</b> consisting of 3 phases.   | Set                 | 5781.00    |
| 30) | Labour charges for <b>erection of 33 or 11 KV C.Ts</b> including all connections.   |                     |            |
| a)  | 33 KV CTs   | Each                | 370.00     |
| b)  | 11 KV CTs   | Each                | 255.00     |
| 31) | Labour charges for erection of <b>HT metering cubicle</b> including all connections and earthing as per departmental standards.   | Each                | 579.00     |
| 32) | Labour charges for erection of <b>HT Trivector meter box</b> including all connections and earthing as per departmental standards.  | Each                | 370.00     |
| 33) | Dismantling and Re-erection of Single Phase/ Three Phase services ( Any where in the district same rate only. NO EXTRA RATE TOWARDS AREA ALLOWANCES IS ALLOWED)   | One Service         | 20.00      |
| 34) | Extra percentage towards work involving (a) Single Pole (b) Two Pole (c) Three Poles (This rate is applicable to both Urban and Rural areas)  |                     |            |
| a)  | Single Pole   |                     | 100% extra |

|     |   |                          |           |
|-----|---|--------------------------|-----------|
| b)  | Two Poles   |                          | 50% extra |
| c)  | Three Poles   |                          | 20% extra |
| 35) | (a) Labour charges for rectification of all types of leaned poles where the lean is more than 30 degree to the vertical.  | 35% of Erection Charges  |           |
|     | (b) Charges for restringing of loose spans  | 50% of stringing charges |           |
| 36) | Labour charges for fixing of tube light fitting for street light  | Each                     | 116.00    |
| 37) | Labour charges for fixing of MV/SV lamp fitting for street light  | Each                     | 128.00    |
| 38) | Laying of earth mat/risers including excavation of trenches, welding, fixing lugs, connecting to equipment and refilling trenches using MS flat 75x8mm or 50x8mm.   |                          |           |
| a)  | 75x8mm  | RM                       | 54.00     |
| b)  | 50x8mm  | RM                       | 36.00     |
| 39) | Providing <b>security fencing</b> of size 2.4m x 3m x3m (total area 28.8 sqm) <b>to Distribution Transformer structures</b> with gate and locking arrangement which is one side removable and three sides fixed fencing as per the dimensions mentioned in the drawing using G.I. Chain link mesh 8 guage 50.8mm x 50.8mm (2" x 2") size, MS angle 50 x 50 x 6, MS flat 35 x 6, MS flat 25 x 6, bolts, nuts, Aldrop, hinges, concreting the supports with PCC (1:4:8), painting one coat red oxide, two coats synthetic enamel paint, complete for finished item of work.<br><b>Note:- Works are to be executed on seeking estimate sanction from the corporate office.</b><br><b>Whenever it is not possible to provide fencing of size 2.4mx3mx3m, then size may be reduced and payment may be arranged based on the actual area.</b> |                          |           |
| a)  | Rural areas   | Sqm                      | 872.00    |
| b)  | All other areas   | Sqm                      | 892.00    |
|     | <b><u>Painting of Old structures/ equipment in 33/11 KV SS</u></b><br>Note:-1) <b>Red oxide paint is not allowed for old structures.</b><br>2) <b>Only one coat of aluminium paint or synthetic enamel paint or black bitumen paint is allowed for old structures/ equipment.</b>   |                          |           |
| 40) | <b>Painting of old structures with one coat of aluminium paint</b> including cost and conveyance of paints, brushes, labour complete.   |                          |           |
| a)  | Cost of paint   | Sqm                      | 26.00     |
| b)  | Labour charges  | Sqm                      | 36.00     |
| c)  | Total (Cost of paint + labour charges)  | Sqm                      | 62.00     |
| 41) | <b>Painting of old equipment</b> including transformers, VCBs, breakers with <b>one coat of synthetic enamel paint</b> including cost and conveyance of paints, brushes, labour complete.   |                          |           |
| a)  | Cost of paint   | Sqm                      | 20.00     |
| b)  | Labour charges  | Sqm                      | 36.00     |
| c)  | Total (Cost of paint + labour charges)  | Sqm                      | 57.00     |
| 42) | <b>Painting of old structures with one coat of Anti corrosive bitumen black paint</b> including cost and conveyance of paints, brushes, labour complete.  |                          |           |
| a)  | Cost of paint   | Sqm                      | 38.00     |
| b)  | Labour charges  | Sqm                      | 36.00     |
| c)  | Total (Cost of paint + labour charges)  | Sqm                      | 75.00     |

|            |  |            |         |
|------------|--|------------|---------|
| <b>43)</b> | <b>Painting of new structures/ equipment in 33/11 KV SS with one coat of Red oxide paint and two coats of aluminum paint.</b>  |            |         |
| <b>a)</b>  | Cost of paint  | Sqm        | 80.00   |
| <b>b)</b>  | Labour charges   | Sqm        | 64.00   |
| <b>c)</b>  | Total (Cost of paint + labour charges)   | Sqm        | 144.00  |
| <b>44)</b> | <b>Painting of new structures/ equipment in 33/11 KV SS with one coat of Red oxide paint and two coats of synthetic enamel paint.</b>  |            |         |
| <b>a)</b>  | Cost of paint  | Sqm        | 64.00   |
| <b>b)</b>  | Labour charges   | Sqm        | 64.00   |
| <b>c)</b>  | Total (Cost of paint + labour charges)   | Sqm        | 128.00  |
|            | <b>DISMANTLING</b>   |            |         |
| <b>45)</b> | For all <b>dismantling works 50%</b> of erection charges shall be adopted. For poles dismantling charges at 50% is allowed only, if they are retrieved in good condition.  |            |         |
|            | <b>MRT WORKS</b>   |            |         |
| <b>46)</b> | Labour for <b>opening of the top cover of CSP Transformer</b> by cutting with grinder and welding/fixing with bolts and nuts of the top cover for various capacities of Distribution transformers ie.,63 KVA,100KVA 250 KVA and 500 KVA at SPM shed inclusive of cost of welding electrodes, cost of bolts and nuts and drilling of holes  | Each       | 1456.00 |
| <b>47)</b> | Labour charges for <b>reclamation of used transformer oil</b> at MRT shed  | Kilo litre | 4162.00 |
| <b>48)</b> | <b>Providing of MS vent pipe with diaphragm to the top cover of the D.Tr.</b> The vent Pipe consists of 50mm dia, 4mm thick copper foil should be fixed between flange of the Nipple and 180 bend. Wire gauge protection should be provided at the end of the bend Duly providing flange.  | Each       | 879.00  |
|            | Note:- For the above three items of work the required machinery and material except general consumables such as cotton waste etc., shall be supplied by the Dept at free of cost   |            |         |
| <b>49)</b> | Handling, testing, providing of seals with cover, stacking neatly.   |            |         |
| <b>a)</b>  | S phase energy meter.  | Each       | 9.00    |
| <b>b)</b>  | Testing of 3 Phase energy meter  | Each       | 16.00   |
| <b>50)</b> | Removing the meter back cover, cleaning the old meter cover, painting the meter top & bottom covers with good approved enamel black paint, cleaning the meter with petrol and oiling to bearings with good 2 in 1 oil (Usha make) refixing the meter in meter cover duly providing new gaskets. Testing and adjustments of the meter as per departmental standards, loading, transporting, and unloading including introducing sealing wire to each meter including replacement of glass wherever necessary. |            |         |
| <b>a)</b>  | Including cost of paint  | Each       | 24.00   |
| <b>b)</b>  | Excluding cost of paint  | Each       | 18.00   |
| <b>51)</b> | Removal or fixing of PC coil, CC coil or Disc, cyclometer or terminal block.   | Each       | 2.50    |
| <b>52)</b> | Labour charges for sealing of single phase/3 phase meters including transportation of meter box carton to work spot, unpacking, packing  |            |         |

|     |  |      |        |
|-----|--|------|--------|
|     | of sealed meters and stocking etc., complete.  |      |        |
| a)  | 2 Seals  | Each | 5.00   |
| b)  | 3 Seals  | Each | 5.50   |
| c)  | 4 Seals  | Each | 8.50   |
| 53) | Labour charges for sealing of S Phase/ 3 phase energy meters housed in PP box including transportation unpacking and packing and stocking of meter box etc., complete.   |      |        |
| a)  | 2 Seals  | Each | 5.50   |
| b)  | 3 Seals  | Each | 10.50  |
| c)  | 4 Seals  | Each | 13.00  |
| d)  | 6 Seals  | Each | 20.00  |
| 54) | <b><u>Metering arrangement with CTs to 16/25 KVA Agricultural DTRs</u></b>   |      |        |
| a)  | Supply and rigging of meter with country wood of size 1'x1/2', 7/20 finolex wire, bolts and nuts and screws along with lugs. Removing of metallic strip in syntex box, fixing of wooden board suitably, fixing of meter and CT in position including fixing of neutral terminal bolt. Providing of internal wiring duly giving proper connections, opening of internal link in the meter duly providing sealing after testing. ( energy meter and box will be supplied by the dept)  | Each | 601.00 |
| b)  | Supply and fixing of 2meters of aluminium cable, 05m of 3/20 copper wire, 2 sets of clamps with bolts and nuts and misc items like insulation tapes, screws etc., including labour charges for fixing of box and transport charges including loading and unloading.  | Each | 277.00 |
|     | <b>.do. with 4 sets of clamps</b>  | Each | 324.00 |
|     | <p><b><u>FABRICATION OF LINE MATERIALS:-</u></b><br/> <b>Important Note:.</b> (1)All the fabrication works should be done by using department materials within stores yard/premises only. Department Materials shall not be issued to the out side the stores, for fabrication purpose. Divisional Engineer/ Tech shall monitor the issue of fabrication material.</p> <p><b><u>(2) No extra rate towards area allowance is allowed in respect of fabrication of line materials</u></b></p> <p><b><u>(3)Fabrication rates are inclusive of cost of Power, welding rods, Oxygen and Acetylene for cutting, welding and cutting charges, bending charges, drilling charges, red oxide paint. In case any of the above mentioned items are done in our dept workshop with the help of machinery, material and staff then accordingly rate is to be reduced from these approved rates.</u></b></p> |      |        |
| 55) | <b>CUTTING CHARGES:-</b>   |      |        |
| a)  | 60 lbs. Rail poles   | Each | 30.00  |
| b)  | 90 lbs. Rail poles   | Each | 46.00  |
| c)  | 105 lbs. Rail poles  | Each | 46.00  |
| d)  | R.S. Joists of various sizes   | Each | 23.00  |
| e)  | M.S. Channels of size 75 x 40 mm. and 80 x 40 mm   | Each | 7.00   |
| f)  | M.S. Channels of size 100 x 50 mm. and 125 x 65 mm   | Each | 8.00   |



|            |   |      |        |
|------------|---|------|--------|
| g)         | M.S. Channels of size 150 x 75 mm. and above  | Each | 12.00  |
| h)         | M.S. Angles of sizes 50 x 50 x 6 mm. and 55 x 55 x 5 mm.  | Each | 3.50   |
| i)         | M.S. Angles of size 65 x 65 x 6 mm. and above   | Each | 4.50   |
| j)         | M.S. Flat 75 x 8 mm.  | Each | 2.50   |
| k)         | M.S. Flat of size 50 x 6 mm.  | Each | 2.50   |
| l)         | M.S. Flat of width below 50 mm.   | Each | 1.50   |
| m)         | M.S. Rounds up to 23 mm.  | Each | 2.50   |
| <b>56)</b> | <b><u>DRILLING CHARGES</u></b>  |      |        |
| a)         | Charges for drilling of holes to various sizes of angle, channel and flats.   |      |        |
| i)         | For holes up to 18 mm.  | Each | 2.50   |
| ii)        | For holes above 18 mm   | Each | 3.50   |
| b)         | Drilling of holes of various sizes to R.S. Joists and Rail poles with ratchet or hand Drilling machine:   |      |        |
| i)         | For R.S. Joists   | Each | 4.50   |
| ii)        | For 60 lbs. Rail poles  | Each | 5.00   |
| iii)       | For 90 lbs. Rail poles  | Each | 6.00   |
| c)         | Drilling of holes of various sizes to R.S. Joists or Rails poles using power drilling Machine:.   |      |        |
| i)         | For R.S. Joists   | Each | 3.50   |
| ii)        | For 60 lbs. Rail poles  | Each | 4.50   |
| iii)       | For 90 lbs. And 120 lbs Rail  | Each | 5.50   |
| <b>57)</b> | <b><u>FABRICATION CHARGES: Fabrication of the following materials including cost of consumables, cutting, drilling charges, but excluding the cost of raw materials</u></b> |      |        |
| a)         | <b>33 KV "V" Cross arms with 100x50 mm MS Channel 2.08mtrs(6'.10") – Weight of the materials=19.0 Kg</b>  | Each | 453.00 |
| b)         | <b>11KV "V" Cross arms .</b>  |      |        |
| i)         | With 75x40 mm M.S. Channel . Weight of the materials = 9 Kgs.(with 4 nos 50x50x6 packing plates are welded)   | Each | 410.00 |
| ii)        | With 65x65x6mm M.S. Angle – . Weight of the materials =8.2 Kgs  | Each | 233.00 |
| c)         | <b>LT 3.Phase 4 Wire Cross arms.</b>  |      |        |
| i)         | With 50x50x6mm M.S. Angle( 3'.8") . Weight of the materials = 5.75 Kgs.   | Each | 118.00 |
| ii)        | With 65x65x6mm M.S. Angle ( 3'.8") – Weight of the materials = 7 Kgs  | Each | 122.00 |
| d)         | <b>LT 3.Phase 5 Wire Cross arms ..</b>  |      |        |
| i)         | With 50x50x6mm M.S. Angle(4'.5")– Weight of the materials = 7.3 Kgs   | Each | 144.00 |
| ii)        | With 65x65x6mm M.S. Angle ( 4'.5") – Weight of the materials = 9.6 Kgs  | Each | 147.00 |
| e)         | <b>LT S.Phase 3 Wire Cross arms with 50x50x6mm M.S. Angle (2'.5") = Weight of the materials = 4.2 Kgs.</b>  | Each | 93.00  |
| f)         | <b>M.S. Stay sets</b>   |      |        |
| i)         | <b>M.S. Stay sets with 20 mm M.S. Rod &amp; Stay Clamps with 100x50mm M.S. Channel . Weight of the materials = 10.3 Kgs</b>   | Each | 126.00 |
| ii)        | <b>M.S. Stay sets with 20 mm M.S. Rod &amp; Stay Clamps with 75</b>   | Each | 118.00 |

|      |  |      |        |
|------|--|------|--------|
|      | <b>x40mm M.S. Channel</b> . Weight of the materials = 10.2 Kgs.  |      |        |
| iii) | <b>M.S. Stay sets with 16mm M.S. Rod &amp; Stay Clamps with 100x50mm M.S. Channel</b> .Weight of the materials = 8.0 Kgs   | Each | 120.00 |
| iv)  | <b>M.S. Stay sets with 16mm M.S. Rod &amp; Stay Clamps with 75x40xmm M.S. Channel</b> .Weight of the materials = 7.6 Kgs   | Each | 113.00 |
| v)   | <b>M.S. Stay sets with 16mm M.S. Rod &amp; Stay Clamps with 50x50x6mm M.S. Angle</b> – Weight of the materials = 6.3 Kgs   | Each | 109.00 |
| g)   | <b>33KV Top Fitting</b>  |      |        |
| i)   | <b>33KV Top Fitting</b> with Clamps with 75x40mm M.S. Channel . Weight of the materials = 6.9 Kgs.   | Each | 126.00 |
| ii)  | <b>33KV Top Fitting</b> with Clamps with 65x65x6mm M.S. angle . Weight of the materials = 6.5 Kgs.   | Each | 113.00 |
| h)   | <b>11KV Top Fittings</b>   |      |        |
| i)   | <b>11KV Top Fittings</b> with Clamps 65x65x6mm M.S. Angle – Weight of the materials = 4.4 Kgs.   | Each | 113.00 |
| ii)  | <b>11KV Top Fittings</b> with Clamps 50x50x6mm M.S. Angle . Weight of the materials = 3.63Kgs.   | Each | 109.00 |
| iii) | <b>11KV Special Top Fittings</b> with Clamps (2'.0" Height ) 50x50x6mm M.S. Angle – Weight of the materials = 3.6Kgs.  | Each | 109.00 |
| i)   | <b>LT Top Fittings</b> with Clamps 50x6mm M.S. Flat – Weight of the materials = 2.4 Kgs.   | Each | 35.00  |
| j)   | <b>11KV Tapping Cross arms</b> with (5.6") 100x50mm M.S. Channel – Weight of the materials =13.4 Kgs   | Each | 71.00  |
| k)   | <b>11KV Tapping Cross arms</b> with (5.6") 75x40mm M.S. Channel – Weight of the materials = 11.2 Kgs.  | Each | 111.00 |
| l)   | <b>33KV Tapping Cross arms</b> with (7'.0") 100x50mm M.S. Channel – Weight of the materials = 16.2 Kgs.  | Each | 75.00  |
| m)   | <b>HT/LT Side arms with strut</b><br>(7'.6") 75x40mm M.S. Channel<br>(7'.6") 50x50x6mm M.S. Angle<br>(3'.6") 50x50x6mm M.S. Angle<br>(3'.0") 50x50x6mm M.S. Angle – Weight of the materials = 37.600Kgs. | Each | 104.00 |
| n)   | <b>LT Side arms with strut</b><br>(5'.6") 50x50x6mm M.S. Angle<br>(6'.0") 50x50x6mm M.S. Angle – Weight of the materials = 15.600Kgs.  | Each | 151.00 |
| o)   | <b>M.S Back Clamps (1'.3")</b>   |      |        |
| i)   | With 50x6mm M.S. Flat for 8m/140 Kg Pole – Weight of the materials = 0.84 Kgs.   | Each | 15.00  |
| ii)  | With 50x6mm M.S. Flat for 8m/200 Kg Pole – Weight of the materials = 0.924 Kgs.  | Each | 15.00  |
| iii) | With 75x8mm M.S. Flat for 9.1m/280 Kg Pole – Weight of the materials = 2.17 Kgs.   | Each | 16.00  |
| p)   | <b>M.S. Stay Clamps (1'.1" X 2Nos.)</b><br>50x6mm M.S. Flat – Weight of the materials = 1.640Kgs.  |      |        |
| i)   | For 8m/140 Kg Pole – Weight of the materials = 1.38 Kgs.   | Each | 24.00  |
| ii)  | For 8m/200 Kg Pole – Weight of the materials = 1.416 Kgs.  | Each | 25.00  |
| iii) | For 9.1m/280 Kg Pole – Weight of the materials = 3.71 Kgs.   | Each | 31.00  |

|            |  |          |        |
|------------|--|----------|--------|
| <b>q)</b>  | Pole mounting arrangement for 3.Phase 16/25 KVA DTR'S<br>(4'.0=2Nos.) 75x40mm M.S. Channel<br>(5'.0"=1No) 50x50x6mm M.S. Angle<br>(1'.6"=2Nos.)50x50x6mm M.S. Angle<br>(1'.1"=2Nos.)50x50x6mm M.S. Flat – Weight of the materials =<br>26 Kgs. | Each     | 228.00 |
|            | <b>NEW ITEMS</b>   |          |        |
| <b>r)</b>  | D.P. Structures total set<br>10' – 2Nos. 100 x 50 MS Channel<br>10' .2Nos. 50 x 50x 6 Angle<br>3' – 3 Nos. 75 x 40 Channel<br>2' – 4Nos. 50 x 6 MS Flat  | Each set | 473.00 |
| <b>s)</b>  | Spun Pole Clamps   |          |        |
|            | i) Back Clamps   | Each     | 27.00  |
|            | ii) Stay Clamps  | Each     | 22.00  |
| <b>t)</b>  | Extension Pieces   | Each     | 137.00 |
| <b>u)</b>  | Single Phase pole mounting   |          |        |
| <b>v)</b>  | HT/LT Spun Pole mounting<br>8' – 100 x 50 Channel<br>21' – 65 x 65 Angle<br>12' – 75 x 8 MS Flat   | Set      | 320.00 |
| <b>w)</b>  | AB Switch OFF & ON Base with Clamp   | Set      | 55.00  |
| <b>58)</b> | <b>WELDING CHARGES:.</b>   |          |        |
| <b>59)</b> | <b>ARC WELDING</b> charges for all steel materials to a length of 25 mm.(1") of weld including cost of power and electrodes.   |          |        |
| <b>a)</b>  | Double welding   | 25mm     | 12.00  |
| <b>b)</b>  | Single welding   | 25mm     | 5.50   |
| <b>60)</b> | <b>GAS WELDING</b> charges for all steel materials to a length of 25 mm.(1") of weld including cost of gas   | 25mm     | 10.50  |
| <b>61)</b> | <b>GAS CUTTING</b>   | 25mm     | 4.00   |
| <b>62)</b> | Structural Steel erection Charges  | 1Kg      | 16.00  |

#### IV. LOADING AND UN.LOADING CHARGES

**(No extra rate towards area allowance is allowed in respect of loading and unloading charges)**

| S. No.       | Item                                     | Unit | Loading | Un.loading |
|--------------|--|------|---------|------------|
| <b>1)</b>    | <b><u>POLES/ SUPPORTS</u></b>            |      |         |            |
| <b>a)</b>    | <b>PSCC POLES</b>                        |      |         |            |
| <b>i)</b>    | 8m /140 Kg.                              | Each | 73.00   | 25.00      |
| <b>ii)</b>   | 8m/ 200 Kg                               | Each | 73.00   | 25.00      |
| <b>iii)</b>  | 8m/300 Kg                                | Each | 109.00  | 36.00      |
| <b>iv)</b>   | 9.1 m/280 Kg.                            | Each | 122.00  | 36.00      |
| <b>b)</b>    | <b>SPUN POLES</b>                        |      |         |            |
| <b>i)</b>    | 11m /350 Kg                              | Each | 267.00  | 86.00      |
| <b>ii)</b>   | 12.5m /350 Kg                            | Each | 315.00  | 98.00      |
| <b>c)</b>    | <b>RS JOISTS /RAIL POLES</b>             |      |         |            |
| <b>i)</b>    | RS Joists 150x150 or 175x80 (10m)        | Each | 73.00   | 25.00      |
| <b>ii)</b>   | Rail poles 60 lbs (27 feet)              | Each | 48.00   | 15.00      |
| <b>iii)</b>  | Rail poles 90 lbs. (30 feet)             | Each | 79.00   | 25.00      |
| <b>d)</b>    | <b>RCC Base plates</b>                   | Each | 2.50    | 2.50       |
| <b>2)</b>    | <b><u>TRANSFORMERS</u></b>               |      |         |            |
| <b>a)</b>    | <b>Power Transformers</b>                |      |         |            |
| <b>i)</b>    | 1.6 MVA                                  | Each | 1724.00 | 1724.00    |
| <b>ii)</b>   | 3.15 MVA                                 | Each | 5620.00 | 5620.00    |
| <b>iii)</b>  | 5.0 MVA                                  | Each | 7025.00 | 7025.00    |
| <b>iv)</b>   | 8.0 MVA                                  | Each | 8430.00 | 8430.00    |
| <b>b)</b>    | <b>Distribution Transformers</b>         |      |         |            |
| <b>i)</b>    | Single Phase 5 KVA                       | Each | 61.00   | 61.00      |
| <b>ii)</b>   | Single Phase 15 KVA or 3 Phase 16/25 KVA | Each | 134.00  | 134.00     |
| <b>iii)</b>  | DTRs up to 100 KVA                       | Each | 243.00  | 243.00     |
| <b>iv)</b>   | Amorphous make DTRs 100 KVA              | Each | 304.00  | 304.00     |
| <b>v)</b>    | DTRs from –160 KVA                       | Each | 365.00  | 365.00     |
| <b>vi)</b>   | DTRs from –250 KVA to 315 KVA            | Each | 608.00  | 608.00     |
| <b>vii)</b>  | 33 KV P.T. (or) C.T.                     | Each | 134.00  | 134.00     |
| <b>viii)</b> | 11 KV P.T. (or) C.T.                     | Each | 67.00   | 67.00      |
| <b>c)</b>    | <b>Isolators</b>                         |      |         |            |
| <b>i)</b>    | 33 KV AB switch                          | Each | 57.00   | 57.00      |
| <b>ii)</b>   | 11 KV AB switch                          | Each | 29.00   | 29.00      |
| <b>iii)</b>  | 11 KV H.G. Fuse set                      | Each | 7.50    | 7.50       |
| <b>iv)</b>   | L.T. H.G. Fuse set                       | Each | 6.00    | 6.00       |
| <b>3)</b>    | <b><u>EQUIPMENT</u></b>                  |      |         |            |
| <b>a)</b>    | 33 KV VCB                                | Set  | 971.00  | 971.00     |
| <b>b)</b>    | 11 KV VCB                                | Set  | 801.00  | 801.00     |

|      |   |            |        |        |
|------|---|------------|--------|--------|
| c)   | 11 KV control panels  | Each       | 109.00 | 109.00 |
| d)   | 11 KV Metering cubicle  | Set        | 145.00 | 145.00 |
| e)   | Batteries   | Each       | 2.50   | 2.50   |
| f)   | Trickal Chargers with batteries   | Each       | 25.00  | 25.00  |
| 4)   | <b><u>IRON MATERIALS</u></b>  |            |        |        |
| a)   | Iron and steel materials, H.T., Mild. steel wire, stay wire, G.I. Wire etc., and stacking | MT         | 218.00 | 218.00 |
| b)   | D.P. structural materials   | Set        | 25.00  | 25.00  |
| c)   | Seating arrangements of 3 phase 16/25 KVA DTRS  | Each       | 12.00  | 12.00  |
| d)   | 33 KV ' V' cross arms   | Each       | 4.50   | 4.50   |
| e)   | 11 KV ' V' cross arms   | Each       | 4.00   | 4.00   |
| f)   | Three phase cross arms  | Each       | 1.50   | 1.50   |
| g)   | Single phase cross.arm  | Each       | 1.00   | 1.00   |
| h)   | 33 KV Top Fittings  | Each       | 2.50   | 2.50   |
| i)   | 11 KV Top Fittings  | Each       | 2.00   | 2.00   |
| j)   | L.T Top Fittings  | Each       | 1.00   | 1.00   |
| k)   | Back clamps   | Each       | 1.00   | 1.00   |
| l)   | Stay clamps set   | Set        | 1.00   | 1.00   |
| m)   | Stay set  | Set        | 4.00   | 4.00   |
| n)   | G.I. Earth pipes  | Each       | 2.00   | 2.00   |
| o)   | C.I. Earth Pipes  | Each       | 7.50   | 7.50   |
| p)   | 'A' Type Distribution Box   | Each       | 6.00   | 6.00   |
| q)   | B' type distribution box  | Set        | 2.50   | 2.50   |
| 5)   | M.S Bolts & Nuts and GI Bolts & Nuts  | Kg         | 0.50   | 0.50   |
| 6)   | <b><u>INSULATORS &amp; PINS</u></b>   |            |        |        |
| a)   | 33KV  |            |        |        |
| i)   | 33 KV Post type Insulators  |            |        |        |
| (1)  | 2 piece type  | Each piece | 1.00   | 1.00   |
| (2)  | Single piece solid core type  | Each       | 1.60   | 1.60   |
| ii)  | 33 KV Pin Insulators  | Each       | 1.40   | 1.40   |
| iii) | 33 KV G.I. Pins   | Each       | 0.60   | 0.60   |
| iv)  | 33 KV Polymer disc  | Each       | 0.60   | 0.60   |
| v)   | 33 KV LAS   | Each       | 24.00  | 24.00  |
| b)   | 11KV  |            |        |        |
| i)   | 11 KV Post type Insulators  | Each       | 1.00   | 1.00   |
| ii)  | 11 KV Pin Insulators  | Each       | 1.00   | 1.00   |
| iii) | 11 KV GI Pins   | Each       | 0.60   | 0.60   |
| iv)  | 11 KV Disc Insulators   | Each       | 1.00   | 1.00   |
| v)   | 11 KV Polymer disc  | Each       | 0.60   | 0.60   |

|              |  |         |        |        |
|--------------|--|---------|--------|--------|
| <b>vi)</b>   | 11 KV/33KV Metal parts   | Set     | 0.60   | 0.60   |
| <b>vii)</b>  | H.T. Guy Insulators  | Each    | 0.70   | 0.70   |
| <b>viii)</b> | 11 KV LAS  |         |        |        |
| <b>(1)</b>   | Station type   | Each    | 12.00  | 12.00  |
| <b>(2)</b>   | Line Type  | Each    | 2.50   | 2.50   |
| <b>c)</b>    | <b>LT</b>  |         |        |        |
| <b>i)</b>    | L.T. Pin Insulators  | Each    | 0.50   | 0.50   |
| <b>ii)</b>   | L.T.G.I. Pins  | Set     | 0.50   | 0.50   |
| <b>iii)</b>  | L.T. Shackles  | Each    | 0.60   | 0.60   |
| <b>iv)</b>   | L.T. metal parts   | Set     | 0.50   | 0.50   |
| <b>v)</b>    | L.T. Guy Insulators  | Each    | 0.60   | 0.60   |
| <b>7)</b>    | <b><u>CONDUCTOR/ CABLE</u></b>   |         |        |        |
| <b>a)</b>    | All Conductor drums  | Drum    | 243.00 | 243.00 |
| <b>b)</b>    | PVC cable above 25 sq.mm., and up to 185 sq.mm/ 33KV/11KV/LT XLPE UG Cable | MT      | 218.00 | 218.00 |
| <b>c)</b>    | PVC cable up to and including 10 sq.mm.,                                   | Coil    | 1.60   | 1.60   |
| <b>d)</b>    | <b>Un coiling of cables/ conductors</b>                                    |         |        |        |
| <b>i)</b>    | Un.coiling of conductor from main drum and loading                         | KM      | 61.00  | 61.00  |
| <b>ii)</b>   | Un.coiling of PVC Cable/ Control cables From 25 to185 Sq.mm                | 100 RM  | 48.00  | 48.00  |
| <b>iii)</b>  | Un.coiling XLPE Power Cable  | Metre   | 9.00   | 9.00   |
| <b>iv)</b>   | Un.coiling of panther conductor  | 100 RM  | 65.00  | 65.00  |
| <b>8)</b>    | <b><u>GENERAL ITEMS</u></b>  |         |        |        |
| <b>a)</b>    | Transformer oil drums with oil   | Each    | 36.00  | 36.00  |
| <b>b)</b>    | Empty oil drums  | Each    | 2.50   | 2.50   |
| <b>c)</b>    | C.T. Meters  | Each    | 7.50   | 7.50   |
| <b>d)</b>    | 3 Phase Meter boxes and CT Meter boxes                                     | Each    | 2.50   | 2.50   |
| <b>e)</b>    | Three phase meters   | Each    | 2.00   | 2.00   |
| <b>f)</b>    | Single phase meters  | Each    | 1.20   | 1.20   |
| <b>g)</b>    | Pilfer proof box   | Set     | 0.90   | 0.90   |
| <b>h)</b>    | Fuse units 16 A to 32 A  | Each    | 0.50   | 0.50   |
| <b>i)</b>    | Fuse units 63 A / 100 A  | Each    | 0.40   | 0.40   |
| <b>j)</b>    | Fuse units 200 A, 300 A  | Each    | 0.60   | 0.60   |
| <b>k)</b>    | Lugs   | Per Box | 0.70   | 0.70   |
| <b>l)</b>    | Male / Female Contacts   | Per Bag | 12.00  | 12.00  |
| <b>m)</b>    | Cable Jointing kits  | Each    | 1.30   | 1.30   |
| <b>n)</b>    | Street light fixture   | Set     | 0.80   | 0.80   |
| <b>o)</b>    | Fuse wire and other MRT Materials  | 1 Kg    | 1.20   | 1.20   |

|             |  |             |        |        |
|-------------|--|-------------|--------|--------|
| <b>p)</b>   | Winding wire up to 5 Kg including weighing.                                | Each real   | 3.20   | 3.20   |
| <b>q)</b>   | Winding wire more than 5 Kg including weighing.                            | Each real   | 7.50   | 7.50   |
| <b>r)</b>   | <b>Paints</b>  |             |        |        |
| <b>i)</b>   | Paints up to & including 5 litres  | Each        | 1.30   | 1.30   |
| <b>ii)</b>  | Paints above 5 litres and up to including 20 litres                        | Each        | 5.00   | 5.00   |
| <b>s)</b>   | Cement   | MT          | 98.00  | 98.00  |
| <b>t)</b>   | <b>Loading and unloading of any other materials</b>                        |             |        |        |
| <b>i)</b>   | up to 10 Kg (Indoor Items)   | Per Bag/Box | 7.50   | 7.50   |
| <b>ii)</b>  | more than 10 Kg (Indoor Items)   | Per Bag/Box | 12.00  | 12.00  |
| <b>iii)</b> | 11KV 200A Tilting Type AB Switch Mounting arrangements for 8.0M PSCC poles | Each        | 8.00   | 8.00   |
| <b>iv)</b>  | 40 KVA DTR mounting arrangements   | Each        | 16.50  | 16.50  |
| <b>v)</b>   | 33KV HV/LV twin feeder panel   | Each        | 115.00 | 115.00 |
| <b>9)</b>   | <b><u>SCRAP</u></b>  |             |        |        |
| <b>a)</b>   | Aluminium scrap, Copper Scrap and Plastic Scrap including weighing         | MT          | 485.00 | 485.00 |
| <b>b)</b>   | Meters Scrap including weighing  | MT          | 485.00 | 485.00 |
| <b>c)</b>   | M S Scrap and lead scrap including weighing                                | MT          | 365.00 | 365.00 |

## V. TRANSPORT CHARGES

### 1.General Transport items:.

| Sl No | Item   | Unit | Rate   |
|-------|--|------|--------|
| 1     | Single bullock with driver and cart                    | Day  | 345.00 |
| 2     | Bullock pair with driver                               | Day  | 350.00 |
| 3     | Bullock pair with driver and cart                      | Day  | 365.00 |
| 4     | Bullock pair with driver and cart with pneumatic tyres | Day  | 384.00 |
| 5     | Nava with crew   | Day  | 335.00 |
| 6     | Punt thundal   | Day  | 251.00 |
| 7     | Punt lascar  | Day  | 251.00 |

### 2.Transport of Cement:-

| Sl No | Lead in KM                | Transport charges of Cement per MT            |
|-------|---------------------------|---|
| 1     | Up to and including 5.0Km | Rs.208.00 Ps.                                 |
| 2     | 5.0Km to 500 Km           | Rs. 208.00 Ps + Rs.5.30 Psper Km above 5.0 Km |
| 3     | Beyond 500 Km             | Rs.3.50 Ps per Km above                       |

### 3. Transport of steel materials( including ribbed rod, HT steel wire, channels, angles, RS joists, rail poles, fabricated materials) and lubricating oil:-

(These rates are excluding the loading, un-loading & stacking charges).

| Sl No | Lead in Km | Transport charges per MT |
|-------|------------|--------------------------|
| 1.    | 0.5 KM     | 237.00                   |
| 2.    | 1.0 KM     | 241.00                   |
| 3.    | 2.0 KM     | 250.00                   |
| 4.    | 3.0 KM     | 261.00                   |
| 5.    | 4.0 KM     | 271.00                   |
| 6.    | 5.0 KM     | 280.00                   |
| 7.    | 6.0 KM     | 304.00                   |
| 8.    | 7.0 KM     | 312.00                   |
| 9.    | 8.0 KM     | 324.00                   |
| 10.   | 9.0 KM     | 333.00                   |
| 11.   | 10.0 KM    | 344.00                   |
| 12.   | 11.0 KM    | 355.00                   |
| 13.   | 12.0 KM    | 364.00                   |



|     |   |        |
|-----|---|--------|
| 14. | 13.0 KM                                   | 375.00 |
| 15. | 14.0 KM                                   | 384.00 |
| 16. | 15.0 KM                                   | 395.00 |
| 17. | 16.0 KM                                   | 403.00 |
| 18. | 17.0 KM                                   | 412.00 |
| 19. | 18.0 KM                                   | 423.00 |
| 20. | 19.0 KM                                   | 433.00 |
| 21. | 20.0 KM                                   | 446.00 |
| 22. | Beyond 20 KM and up to 30<br>KM(Rate/Km)  | 10.00  |
| 23. | Beyond 30 KM and up to 50<br>KM(Rate/Km)  | 8.00   |
| 24. | Beyond 50 KM and up to 80<br>KM(Rate/Km)  | 8.00   |
| 25. | Beyond 80 KM and up to 100<br>KM(Rate/Km) | 7.00   |
| 26. | Beyond 100 Km (Rate/Km)                   | 6.60   |

#### **4.TRANSPORT OF LINE MATERIALS :-**

(A) For leads up to 250KM excluding the loading and un.loading charges.

| <b>Lead in KM</b> | <b>PerTonne</b> | <b>Lead in KM</b> | <b>PerTonne</b> |
|-------------------|-----------------|-------------------|-----------------|
| 0.5 KM            | 204.00          | 11.0 KM           | 296.00          |
| 1.0 KM            | 207.00          | 12.0 KM           | 314.00          |
| 2.0 KM            | 217.00          | 13.0 KM           | 319.00          |
| 3.0 KM            | 225.00          | 14.0 KM           | 323.00          |
| 4.0 KM            | 236.00          | 15.0 KM           | 330.00          |
| 5.0 KM            | 245.00          | 16.0 KM           | 334.00          |
| 6.0 KM            | 254.00          | 17.0 KM           | 339.00          |
| 7.0 KM            | 264.00          | 18.0 KM           | 343.00          |
| 8.0 KM            | 273.00          | 19.0 KM           | 355.00          |
| 9.0 KM            | 279.00          | 20.0 KM           | 363.00          |
| 10.0 KM           | 287.00          |                   |                 |

For leads from 21 KM up to 30 KMs, add Rs. 6.80 for every additional 1KM or part there of.

For leads from 31 KM up to 50 KMs, add Rs. 6.00 for every additional 1KM or part there of.

For leads from 51 KM up to 80 KMs, add Rs. 5.50 for every additional or 1KM part there of.

For leads from 81 KM up to 100 KMs add Rs. 4.60 for every additional 1KM or part there of

For leads from 101 KM up to 250 KM, add Rs.4.00 for every additional 1KM or part there of

(B) For distances of 251 KM and above, flat rates per M.T. per KM, are worked out, and they are to be taken for calculation directly without taking into account the rates given above for various ranges from 20 to 250 KM .

**These rates are as detailed below.**

1. 251 to 300 KM . Rs.5.50
2. 301 to 400 KM . Rs.5.00
3. 401 to 500 KM . Rs.4.90
4. Above 500 KM . Rs.4.60

The above rate are excluding the loading, un loading & stacking charges.

**NOTE :**

- a) Higher rates may be allowed in the marginal limits of slab.
- b) In respect of scattered works, and part loads, the above rates are applicable for working out load KM. This should be applied in the event of necessity for transport of part loads and where there is no scope for utilization of department lorries.
- c) Transport of conductor drums, transformer oil drums, and fragile materials such as kiosks, L.As, Insulators, Transformers, Meters etc., which occupy more space and less weight, the rates with 20% excess over the rates for line materials shall be adopted.

Loading and un.loading charges are payable extra.

**5.Transport Of PSSC/Spun Poles:**

**a. Pole weights:.**

| SI No | Type of pole          | Weight in Kg/Pole |
|-------|-----------------------|-------------------|
| 1     | 8m/140Kg PSSC pole    | 355 Kg            |
| 2     | 8m/200Kg PSSC pole    | 380 Kg            |
| 3     | 8m/300Kg PSSC pole    | 505 Kg            |
| 4     | 9.1m/280Kg PSSC pole  | 680 Kg            |
| 5     | 11m/365Kg PSSC Pole   | 1127Kg            |
| 6     | 9.5m/300Kg SPUN pole  | 620 Kg            |
| 7     | 11m/350Kg SPUN pole   | 900 Kg            |
| 8     | 12.5m/350Kg SPUN pole | 1200 Kg           |

- b. **Transport by head loads:**.In case of hilly areas 30% extra is to be allowed for transport of poles by head loads.

- c.**Transport by bullock carts:**. Up to 8.0 KM, a rate of Rs.115..00 per pole is to be adopted excluding loading and un loading charges.

d. **Transport by lorries:-**The rates per Metric Tone for leads up to 250 KM are as follows and they are excluding the loading and unloading charges.

| Lead in KM | Per Tonne | Lead in KM | Per Tonne |
|------------|-----------|------------|-----------|
| 0.5 KM     | 255.00    | 11.0 KM    | 398.00    |
| 1.0 KM     | 266.00    | 12.0 KM    | 400.00    |
| 2.0 KM     | 283.00    | 13.0 KM    | 403.00    |
| 3.0 KM     | 293.00    | 14.0 KM    | 410.00    |
| 4.0 KM     | 306.00    | 15.0 KM    | 429.00    |
| 5.0 KM     | 316.00    | 16.0 KM    | 432.00    |
| 6.0 KM     | 331.00    | 17.0 KM    | 434.00    |
| 7.0 KM     | 343.00    | 18.0 KM    | 447.00    |
| 8.0 KM     | 356.00    | 19.0 KM    | 459.00    |
| 9.0 KM     | 370.00    | 20.0 KM    | 486.00    |
| 10.0 KM    | 384.00    |            |           |

For leads from 21 KM up to 30 KM add Rs. 9.90 per 1 KM for every additional KM or part there of.

For leads from 31 KM up to 50 KM add Rs.8.20 per 1 KM) for every additional KM or part there of.

For leads from 51 KM up to 80 KM add Rs. 7.50 per 1 KM for every additional KM or part there of.

For leads from 81 KM up to 100 KM add Rs.6.50 per 1 KM for every additional KM or part there of.

For leads from 101 KM up to 250 KM add Rs.6.00 per 1KM for every additional KM or part there of.

(b) For distances of 251 KM and above, flat rates are worked out for every 100 KM and they shall be taken for calculation directly without taking into account, the rates given above for various ranges from 20 to 250 KM . The flat rates per M.T. per K.M. are detailed below and they are excluding the loading and unloading charges.

1. 251 KM to 300 KM . Rs. 7.50
2. 301 KM to 400 KM . Rs. 7.30
3. 401 KM to 500 KM . Rs. 6.80
4. Above 501 KM . Rs.6.70

Note ∴ Higher rates may be allowed in the marginal limits of slabs.

Security fencing with Gate & locking arrangement  
and one side removable fencing, three sides fixed  
fencing to DTRs.

PLAN

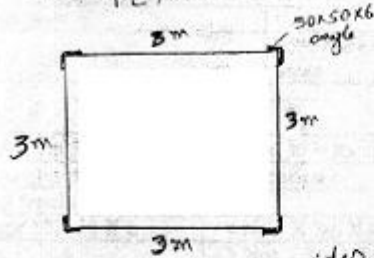

ISOMETRIC VIEW

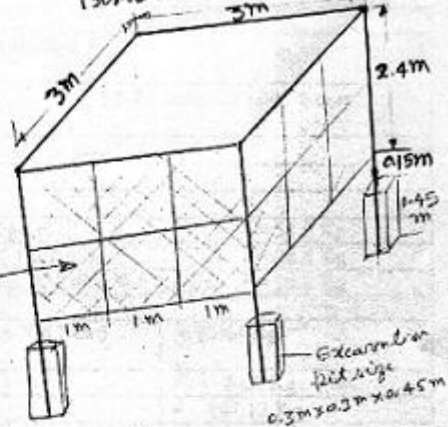

All four sides  
GI chain link mesh  
of 8 gauge of size  
50.8mm x 50.8mm  
(2" x 2") to be  
weld fixed

Elevation of detachable fencing (one side)

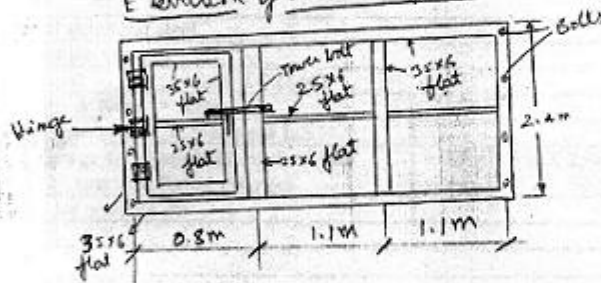

Elevation of fixed fencing (Three sides)

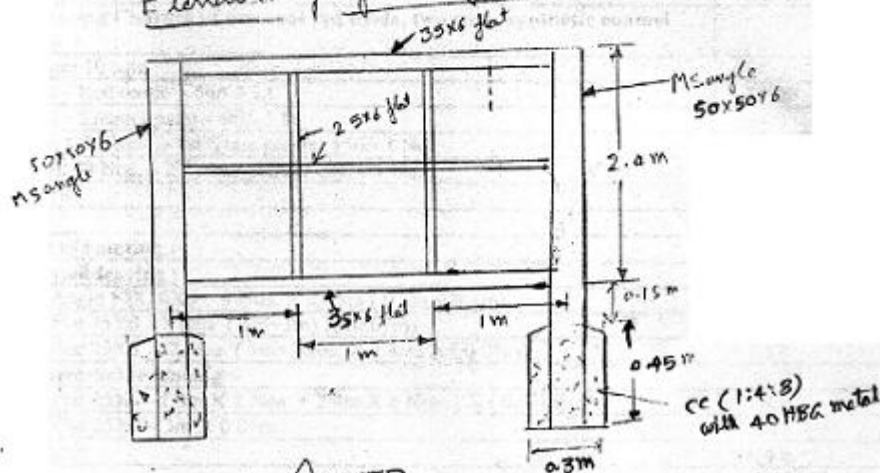

APPROVED

CHIEF GENERAL MANAGER  
Operations & R & D  
APSPCL, TIRUPATI

P. Jagannad  
20/1/16